

接近开关 PROXIMITY SWITCH

结构分类 Structural category 圆柱型 Cylinder type 插件型 Connector type

外形编号 Outward Appearance code LM8-□□T / LM8-□□T3 LM12-□T / LM12-□T3 LM18-□T

外形图例
Outward appearance illustration



外形尺寸
Overall dimensions

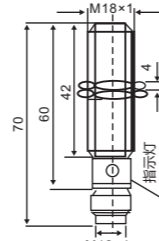
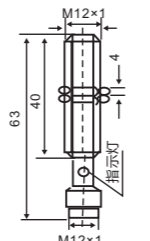
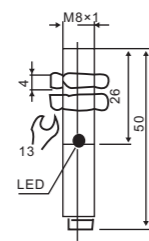

		检测距离 DETECTION DISTANCE				
		1mm	2mm	5mm		
埋入式 Flush	直流 DC 10-30 VDC	NPN	NO	LM8-3001NAT	LM12-3002NAT	LM18-3005NAT
			NC	LM8-3001NBT	LM12-3002NBT	LM18-3005NBT
			NO+NC			
	交流 AC 90-250 VAC	PNP	NO	LM8-3001PAT	LM12-3002PAT	LM18-3005PAT
			NC	LM8-3001PBT	LM12-3002PBT	LM18-3005PBT
			NO+NC			
	二 线 制 two wire system	NO	LM8-3001LAT	LM12-3002LAT	LM18-3005LAT	
		NC	LM8-3001LBT	LM12-3002LBT	LM18-3005LBT	
		SCR 可控硅 Control- lable silicon	NO	LM12-2002AT	LM18-2005AT	
		NC		LM12-2002BT	LM18-2005BT	
继电器输出 Relay output						
		检测距离 DETECTION DISTANCE				
		2mm	4mm			
非埋入式 Non-Flush	直流 DC 10-30 VDC	NPN	NO	LM8-3002NAT	LM12-3004NAT	LM18-3008NAT
			NC	LM8-3002NBT	LM12-3004NBT	LM18-3008NBT
			NO+NC			
	交流 AC 90-250 VAC	PNP	NO	LM8-3002PAT	LM12-3004PAT	LM18-3008PAT
			NC	LM8-3002PBT	LM12-3004PBT	LM18-3008PBT
			NO+NC			
	二 线 制 two wire system	NO	LM8-3002LAT	LM12-3004LAT	LM18-3008LAT	
		NC	LM8-3002LBT	LM12-3004LBT	LM18-3008LBT	
		SCR 可控硅 Control- lable silicon	NO	LM8-2002AT	LM12-2004AT	LM18-2008AT
		NC		LM12-2004BT	LM18-2008BT	
继电器输出 Relay output						
输出电流 Control output		DC	150mA	200mA	300mA	
SCR/继电器 Relay						
输出电压降 Output voltage drop DC/AC		直流(NPN PNP)型3V以下、二线型:3.9V以下、交流AC 10V以下 DC<3V、AC<10V				
消耗电流 Consumption current		直流(NPN PNP)型DC 12V时8mA、24V时15mA、交流AC 10mA以下 DC<15mA、AC<10mA				
标准检测物体 Standard detected object		8×8×1(A3铁iron)	12×12×1(A3铁iron)	18×18×1(A3铁iron)		
重复精度 Repeated precision		0.01	0.01	0.02		
响应频率 DC/AC		500Hz/10Hz	400Hz/10Hz	200Hz/10Hz		
工作环境温度 Working environment temperature		-25°C~+70°C	-25°C~+70°C	-25°C~+70°C		
绝缘电阻 Insulation resistance		50MΩ	50MΩ	50MΩ		
外壳材料 Shell material		金属 Metal	金属 Metal	金属 Metal		
防护等级 Protection grade		IP67	IP67	IP67		
可替代国内型号 Alyemative model at home and abroad		E2E-X1R5-M1	E2E-X2E1-M1	E2E-X5E5-M1		

接近开关 PROXIMITY SWITCH

结构分类 Structural category 圆柱型 Cylinder type

外形编号 Outward Appearance code LM4/LM5 LM6 LM06 LM8

外形图例
Outward appearance illustration



外形尺寸
Overall dimensions

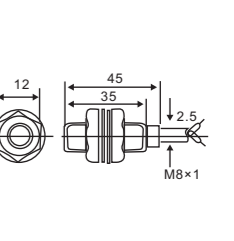
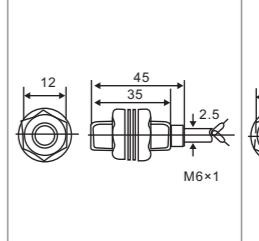
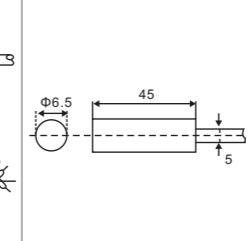
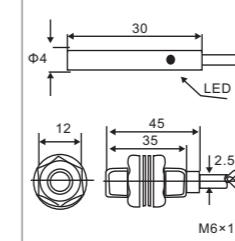

		检测距离 DETECTION DISTANCE					
		0.8mm/1mm	1mm	1mm	1mm	1mm	
埋入式 Flush	直流 DC 10-30 VDC	NPN	NO	LM4-300.8NA/LM5-3001NA	LM6-3001NA	LM06-3001NA	LM8-3001NA
			NC		LM6-3001NB		LM8-3001NB
			NO+NC				LM8-3001NC
	交流 AC 90-250 VAC	PNP	NO	LM4-300.8PA/LM5-3001PA	LM6-3001PA	LM06-3001PA	LM8-3001PA
			NC		LM6-3001PB		LM8-3001PB
			NO+NC				LM8-3001PC
	二 线 制 two wire system	NO		LM6-3001LA		LM8-3001LA	
		NC		LM6-3001LB		LM8-3001LB	
		SCR 可控硅 Control- lable silicon	NO	LM6-2001A		LM8-2001A	
		NC		LM6-2001B		LM8-2001B	
继电器输出 Relay output							
		检测距离 DETECTION DISTANCE		1.5mm	2mm		
非埋入式 Non-Flush	直流 DC 10-30 VDC	NPN	NO		LM6-3002NA	LM8-3002NA	
			NC		LM6-3002NB	LM8-3002NB	
			NO+NC				
	交流 AC 90-250 VAC	PNP	NO		LM6-3002PA	LM8-3002PA	
			NC		LM6-3002PB	LM8-3002PB	
			NO+NC				
	二 线 制 two wire system	NO		LM6-3002LA		LM8-3002LA	
		NC		LM6-3002LB		LM8-3002LB	
		SCR 可控硅 Control- lable silicon	NO	LM6-2002A		LM8-2002A	
		NC		LM6-2002B		LM8-2002B	
继电器输出 Relay output							
输出电流 Control output		DC	200mA	200mA	200mA	200mA	
SCR/继电器 Relay							
输出电压降 Output voltage drop DC/AC		直流(NPN PNP)型3V以下、二线型:3.9V以下、交流AC 10V以下 DC<3V、AC<10V					
消耗电流 Consumption current		直流(NPN PNP)型DC 12V时8mA、24V时15mA、交流AC 10mA以下 DC<15mA、AC<10mA					
标准检测物体 Standard detected object		6×6×1(A3铁iron)	8×8×1(A3铁iron)	8×8×1(A3铁iron)	8×8×1(A3铁iron)		
重复精度 Repeated precision		0.01	0.01	0.01	0.01		
响应频率 DC/AC		500Hz	500Hz	500Hz	500Hz/25Hz		
工作环境温度 Working environment temperature		-25°C~+70°C	-25°C~+75°C	-25°C~+70°C	-25°C~+75°C		
绝缘电阻 Insulation resistance		50MΩ	≥30MΩ	50MΩ	≥50MΩ		
外壳材料 Shell material		金属 Metal	不锈钢 Stainless steel	金属 Metal	金属 Metal		
防护等级 Protection grade		IP67	IP67	IP67	IP67		
可替代国内型号 Alyemative model at home and abroad					E2E-X1R5□□		