

光电开关 PHOTOELECTRIC SWITCH

结构分类 Structural category

光电开关 Photoelectric switch

外形编号 Outward appearance code G12 G13 G14 G15

外形图例
Outward appearance illustration



外形尺寸
Overall dimensions

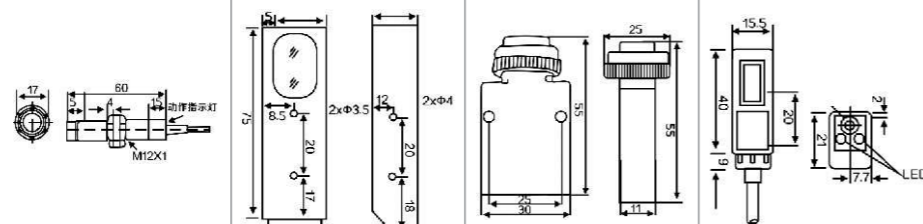

		检测距离 DETECTION DISTANCE		7cm	10cm	10cm	10cm
漫反射型 Retroreflective	直流 DC 10-30 VDC	负逻辑 NPN	常开NO	G12-3A07NA	G13-3A10NA	G14-3A10NA	G15-3A10NA
			常闭NC	G12-3A07NB	G13-3A10NB	G14-3A10NB	G15-3A10NB
			一开一闭NO+NC	G12-3A07NC	G13-3A10NC	G14-3A10NC	G15-3A10NC
		正逻辑 PNP	常开NO	G12-3A07PA	G13-3A07PA	G14-3A07PA	G15-3A07PA
			常闭NC	G12-3A07PB	G13-3A07PB	G14-3A07PB	G15-3A07PB
			一开一闭NO+NC	G12-3A07PC	G13-3A07PC	G14-3A07PC	G15-3A07PC
	交流 AC 90- 250 VAC	SCR可挂硅 Control Hable silicon	常开NO				
			常闭NC				
		继电器输出 Relay output					
		检测距离 DETECTION DISTANCE		1m	1m	1m	1m
反馈反射型 Retroreflective	直流 DC 10-30 VDC	负逻辑 NPN	常开NO	G12-3B1NA	G13-3B1NA	G14-3B1NA	G15-3B1NA
			常闭NC	G12-3B1NB	G13-3B1NB	G14-3B1NB	G15-3B1NB
			一开一闭NO+NC	G12-3B1NC	G13-3B1NC	G14-3B1NC	G15-3B1NC
		正逻辑 PNP	常开NO	G12-3B1PA	G13-3B1PA	G14-3B1PA	G15-3B1PA
			常闭NC	G12-3B1PB	G13-3B1PB	G14-3B1PB	G15-3B1PB
			一开一闭NO+NC	G12-3B1PC	G13-3B1PC	G14-3B1PC	G15-3B1PC
	交流 AC 90- 250 VAC	SCR可挂硅 Control Hable silicon	常开NO				
			常闭NC				
		继电器输出 Relay output					
		检测距离 DETECTION DISTANCE		3m	3m	3m	3m
对射型 Through beam	直流 DC 10-30 VDC	负逻辑 NPN	常开NO	G12-3C3NA	G13-3C3NA	G14-3C3NA	G15-3C3NA
			常闭NC	G12-3C3NB	G13-3C3NB	G14-3C3NB	G15-3C3NB
			一开一闭NO+NC	G12-3C3NC	G13-3C3NC	G14-3C3NC	G15-3C3NC
		正逻辑 PNP	常开NO	G12-3C3PA	G13-3C3PA	G14-3C3PA	G15-3C3PA
			常闭NC	G12-3C3PB	G13-3C3PB	G14-3C3PB	G15-3C3PB
			一开一闭NO+NC	G12-3C3PC	G13-3C3PC	G14-3C3PC	G15-3C3PC
	交流 AC 90- 250 VAC	SCR可挂硅 Control Hable silicon	常开NO				
			常闭NC				
		继电器输出 Relay output					
		输出电流 DC/SCR 继电器 Control output		DC:200mA			
消耗电流 DC/AC Consumption current		DC<15mA					
响应时间 DC/AC Response time		DC<2ms					
指向角 Directional angle		3°-10°					
检测物体 Detected object		透明或不透明体 transparent or opaque body					
工作环境温度 Working environment temperature		-25°C~+55°C					
工作环境照度 Intensity of illumination of working environment		太阳光10000LX以下 Sunlight under 10000LX 白炽灯3000LX以下 incandescent lamp under 3000LX					
外壳材料 Shell materia		金属Metal	金属Metal	塑料Plastic	塑料Metal	塑料Metal	
防护等级 Protection grade		IP54	IP54	IP54	IP54	IP54	

光电开关 PHOTOELECTRIC SWITCH

结构分类 Structural category

光电开关 Photoelectric switch

外形编号 Outward Appearance code G16 G17 G18 G23

外形图例
Outward appearance illustration



外形尺寸
Overall dimensions

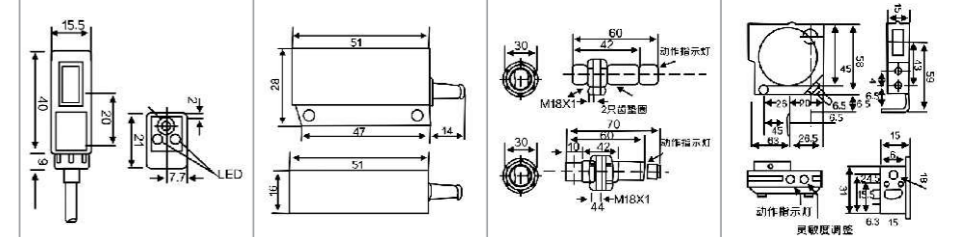

		检测距离 DETECTION DISTANCE		10cm	30cm	10-30cm	10-50cm
漫反射型 Retroreflective	直流 DC 10-30 VDC	负逻辑 NPN	常开NO	G16-3A10NA	G17-3A30NA	G18-3A10NA	G23-3A10NA
			常闭NC	G16-3A10NB	G17-3A30NB	G18-3A10NB	G23-3A10NB
			一开一闭NO+NC	G16-3A10NC	G17-3A30NC	G18-3A10NC	G23-3A10NC
		正逻辑 PNP	常开NO	G16-3A10PA	G17-3A30PA	G18-3A10PA	G23-3A10PA
			常闭NC	G16-3A10PB	G17-3A30PB	G18-3A10PB	G23-3A10PB
			一开一闭NO+NC	G16-3A10PC	G17-3A30PC	G18-3A10PC	G23-3A10PC
	交流 AC 90- 250 VAC	SCR可挂硅 Control Hable silicon	常开NO				G18-2A10LA
			常闭NC				G18-2A10LB
		继电器输出 Relay output					
		检测距离 DETECTION DISTANCE		1m	2m	2m	2m
反馈反射型 Retroreflective	直流 DC 10-30 VDC	负逻辑 NPN	常开NO	G16-3B1NA	G17-3B2NA	G18-3B2NA	G23-3B2NA
			常闭NC	G16-3B1NB	G17-3B2NB	G18-3B2NB	G23-3B2NB
			一开一闭NO+NC	G16-3B1NC	G17-3B2NC	G18-3B2NC	G23-3B2NC
		正逻辑 PNP	常开NO	G16-3B1PA	G17-3B2NA	G18-3B2PA	G23-3B2PA
			常闭NC	G16-3B1PB	G17-3B2NB	G18-3B2PB	G23-3B2PB
			一开一闭NO+NC	G16-3B1PC	G17-3B2NC	G18-3B2PC	G23-3B2PC
	交流 AC 90- 250 VAC	SCR可挂硅 Control Hable silicon	常开NO				G18-2B2LA
			常闭NC				G18-2B2LB
		继电器输出 Relay output					
		检测距离 DETECTION DISTANCE		5m	3m	5m	5m
对射型 Through beam	直流 DC 10-30 VDC	负逻辑 NPN	常开NO	G16-3C5NA	G17-3C3NA	G18-3C5NA	G23-3C5NA
			常闭NC	G16-3C5NB	G17-3C3NB	G18-3C5NB	G23-3C5NB
			一开一闭NO+NC	G16-3C5NC	G17-3C3NC	G18-3C5NC	G23-3C5NC
		正逻辑 PNP	常开NO	G16-3C5PA	G17-3C3PA	G18-3C5PA	G23-3C5PA
			常闭NC	G16-3C5PB	G17-3C3PB	G18-3C5PB	G23-3C5PB
			一开一闭NO+NC	G16-3C5PC	G17-3C3PC	G18-3C5PC	G23-3C5PC
	交流 AC 90- 250 VAC	SCR可挂硅 Control Hable silicon	常开NO				G18-2C5LA
			常闭NC				G18-2C5LB
		继电器输出 Relay output					
		输出电流 DC/SCR 继电器 Control output		DC:200mA, AC:300mA			
消耗电流 DC/AC Consumption current		DC<15mA, AC<10mA					
响应时间 DC/AC Response time		DC<2ms, AC<2ms					
指向角 Directional angle		3°-10°					
检测物体 Detected object		透明或不透明体 transparent or opaque body					
工作环境温度 Working environment temperature		-25°C~+55°C					
工作环境照度 Intensity of illumination of working environment		太阳光10000LX以下 Sunlight under 10000LX 白炽灯3000LX以下 incandescent lamp under 3000LX					
外壳材料 Shell materia		塑料Plastic	塑料Plastic	塑料Plastic	金属Metal	金属Metal	
防护等级 Protection grade		IP54	IP54	IP54	IP54	IP54	